

User-friendly, intuitive and safe



Altivar 32

Variable speed drives
for asynchronous motors,
0.18 to 15 kW



- Metal processing machinery: bending, welding, cutting, etc.
- Textiles
- Wood-working machines
- Lifting machines for the manufacturing sector: conveyors, storage and retrieval systems, handling equipment
- Simple packaging
- Machines with simple control systems: scrolling advertising panels, automatic doors, etc.

+ over 150 application-specific functions

Altivar 32 range

Optimise your industrial machines

More innovations

- Narrower product (45 mm wide)
- Mounting can be vertical, horizontal or on the side.
- Circuit-breaker connected directly to the product
- Built-in Bluetooth®: remote adjustment and parameter setting via mobile phone or PC
- Configuration with the power off in its original packaging
- Independent operation: integrated programmable logic functions

More safety

- Numerous integrated safety functions
- Power supply on each motor starter isolated by its own padlockable circuit-breaker
- Simplified design for greater efficiency

More openness

- Application-oriented
- Access to numerous industrial communication networks
- Synergy between ranges
- Tools adapted to each stage in the product lifecycle

More energy savings

- New control profile for synchronous motors
- Control profile for pumps and fans
- Eco2 software for calculating the energy savings that can be made on your applications

+ 10% energy savings due to the use of synchronous motors:

- New control profile for optimised performance
- Simplification of the gearbox stage for:
 - Direct mounting on pumps and fans
 - Applications requiring significant torque at low speed (bending presses, extruders, etc.)

Altivar 32, packed with innovations

Remote setting and configuration

On-board Bluetooth® for configuration via mobile phone or PC



Simplified user interface for greater efficiency

- 7-segment display: better visibility from a distance
- Navigation button: faster setting
- Ease of identification: product identification on a hinged door on the front panel

RJ45 connection for

- Modbus or CANopen networks
- Dialogue with tools common to the Altivar and Lexium ranges

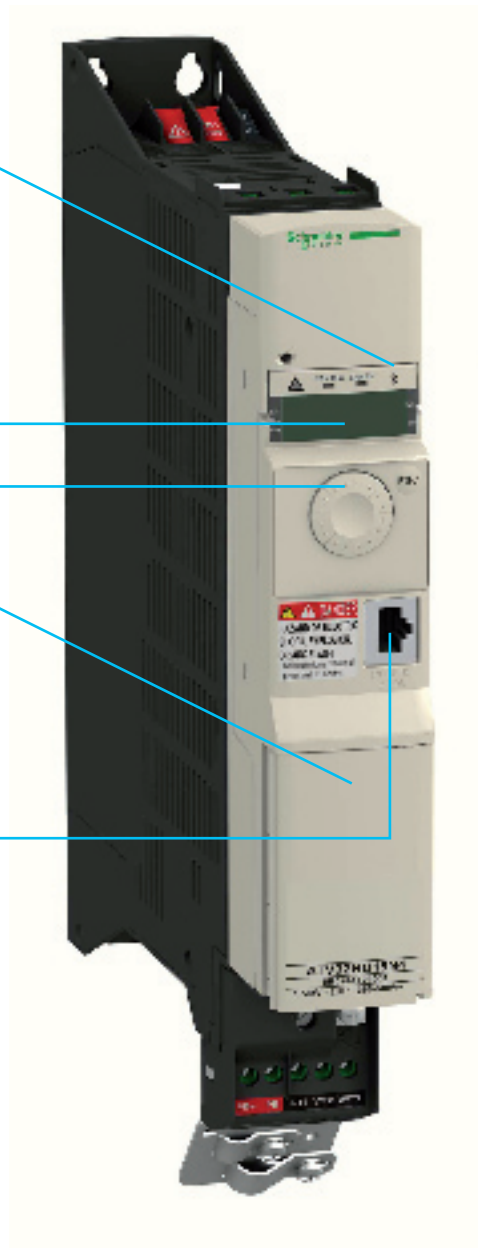

10 drives
configured
in less than
5 minutes
with the
Multiloader!



**Easily
integrated**

- 45 mm wide
(up to 1.5 kW in
400 V version)
- 60 mm wide
(up to 4 kW in
400 V version)



Practical, recyclable packaging

You can configure your Altivar 32 in its packaging, with the power off, without breaking the guarantee seal.

Tools that focus on your applications

Calling all designers, installers, distributors, after-sales technicians, etc. The common platform of tools for the new Altivar and Lexium ranges simplifies your installation and programming times, and cuts your costs.



- Bluetooth® link
- Long distance MMS
- USB connection
- RJ45 connection
- SD transfer

- 1 Multi-Loader: configures and stores the configuration files for several drives on an SD card
- 2 Simple-Loader: duplicates a configuration on two identical drives
- 3 Graphic display terminal: user-friendly programming with a choice of more than 22 languages
- 4 Remote display terminal: simple, low-cost remote display
- 5 Built-in Bluetooth® connection: simplified communication between products equipped with Bluetooth®
- 6 SoMove setup software
- 7 Modbus and CANopen network connection

Open communication

Two software platforms for optimised communication and simpler programming.



SoMachine

Control system programming platform aimed specifically at machine manufacturers.

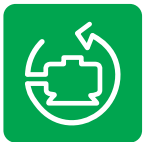

SoMove

Setup software for motor control ranges TeSys, Altistart, Altivar and Lexium.

For the Altivar 32 range:

- Menu customisation
- Creation of configuration files for Multiloader and SoMove Mobile
- Maintenance function (oscilloscope, etc.)
- Programming of logic functions
- Programming of safety functions



SoMove Mobile

Software for loading and adjusting drives via mobile phone.



More autonomy with ATV Logic

- The drive is at the heart of the control system and replaces the simple functions performed by a PLC.
- The software function blocks integrated in the product can be used to:
 - Perform simple control system functions (Boolean, arithmetical operations, timers, counters, comparators, etc.)
 - Write small automated sequences
 - Customise the drive to the machine application
- ATV Logic is programmed with the SoMove software.



Scrolling advertising panel
 Example of functions performed by an Altivar 32

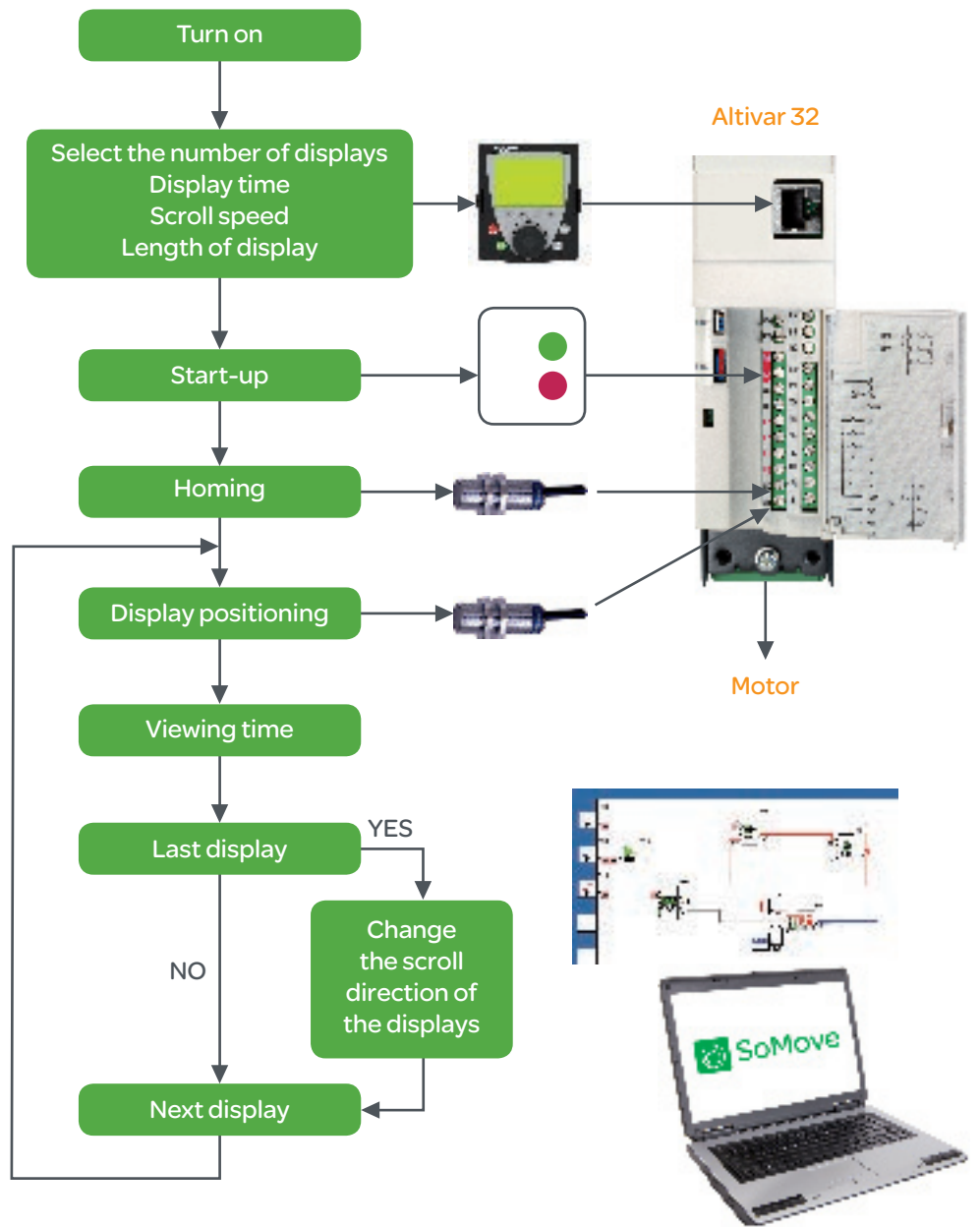

• autonomy
 • savings



• equipment
 • wiring

Safety incorporated as standard

Safety functions for more protection in the machine environment

Certifications:

- Safety Integrity Level 2 (SIL 2) according to IEC 61508 edition 1
- Performance level (PL"d") according to ISO 13849-1 edition 2

STO: Safe Torque Off

Freewheel stop by eliminating the torque on the motor shaft.

SLS: Safely Limited Speed

Slows down then holds the motor at a pre-defined speed, causes STO stopping if this speed is exceeded.

SDI: Safe Direction Information

Monitors the motor direction of rotation, causes STO stopping if motor is running in the opposite direction.

SS1: Safe Stop 1

- Motor stops according to a predefined speed ramp.
- Checks that the motor has actually stopped or has reached a minimum predefined speed then activates the STO function.

Wiring made simple with the terminal diagram on the inside cover

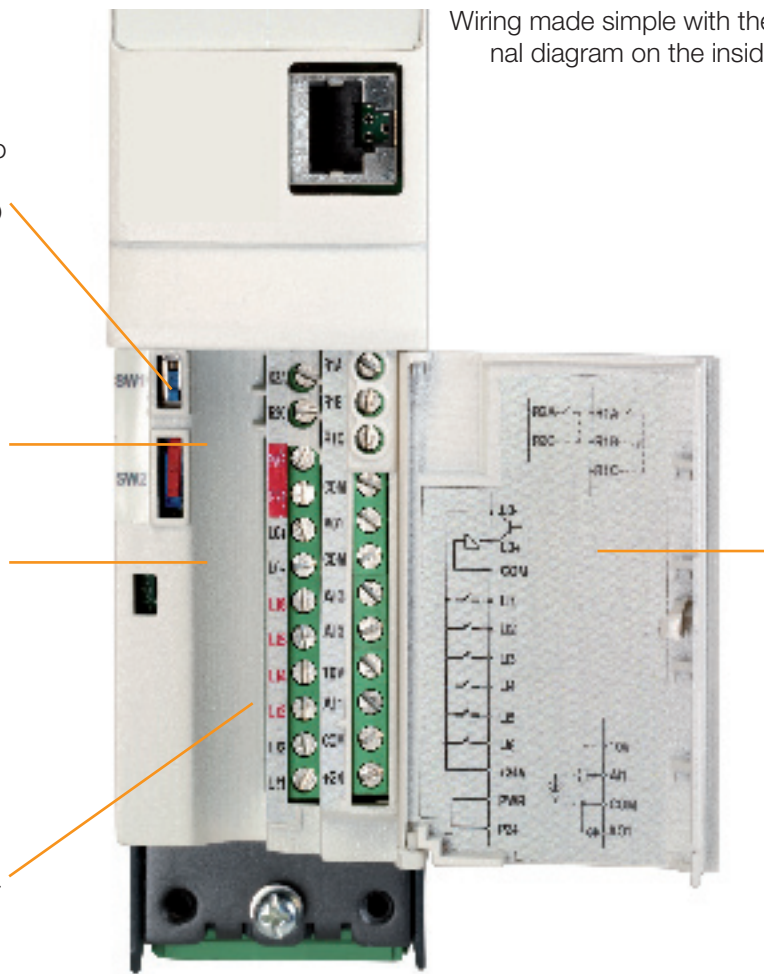

The safety functions can be used in any combination.
Two logic inputs provide redundancy on most of them, hence avoiding the need to use an external safety module.

Safe, simple maintenance

thanks to the terminal block that can be removed (with the power off) from the motor power section

Associated circuit-breaker:

- Padlock ensures you can work on the unit in complete safety
- Continuity of service for the installation with discriminating isolation of the faulty motor starter



- 30% savings compared to a solution with external safety modules
- Altivar 32 is ATEX-certified

Mounting designed to ensure maximum integration

Its extra-slim format and removable front panel optimise Altivar 32's integration into the tiniest spaces (300 mm or less!).



Flexible mounting
Vertical, horizontal or on the side.
Above, mounted at the back of the enclosure with control unit at 90° for ease of access.



Ease of side-by-side mounting



Easy-fit communication modules in cassette format



Horizontal mounting for low-height equipment (in a plug-in base)



Power supply and protection for several drives by means of a busbar and circuit-breakers



Power supply on DC Bus: connection between the DC bus products for balanced loads and optimised energy management



- 40% more space freed up in enclosures
- Up to 10 products side by side instead of 6 fitted widthways!

Totally transparent integration

Altivar 32 integrates into any environment and communicates with any control system product:

- Modbus and CANopen are integrated as standard
- Option cards: CANopen Daisy Chain, Ethernet IP/Modbus TCP Dual Port, EtherCat, Profibus DP V1, DeviceNet, etc.
- Numerous support and design tools (macros for PLCs, mechanical installation software such as AutoCAD, wiring diagram design help software such as ePLAN).

One connection, one software tool for programming the PLC and configuring the drives

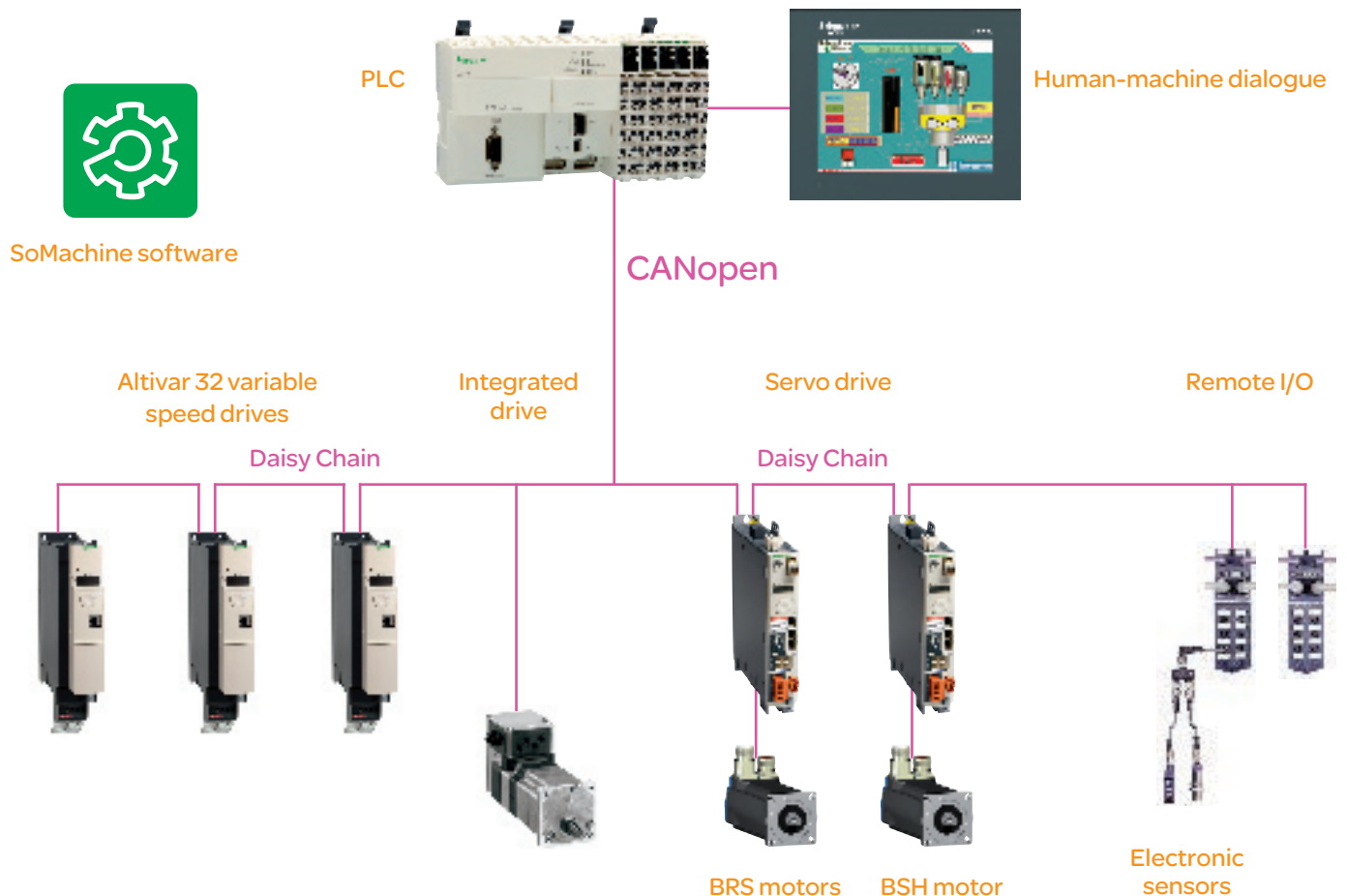

 openness to communication networks

Greater synergy in the control of asynchronous and synchronous motors

Boost your productivity with equipment designed to work together in harmony (circuit-breakers, motor starter, variable speed drives, etc.).

Altivar 32



Lexium 32



- Optimised dimensions for your machines
- Optimised enclosures
- Optimised tool and accessory logistics

Common tools, software and functions



Multiloader

Load and store configurations even with the power off



Graphic display terminal

Configuration and communication in your country's language



Bluetooth

Wireless setup and maintenance



SoMove and SoMove Mobile, SoMachine

Software common to both ranges for a more user-friendly approach



Common functions

- Identical human-machine dialogue
- Integrated safety functions (STO, SLS, SS1)

Mounting and wiring principles

- Extra-slim format, same fixings for side-by-side mounting
- Removable motor connection
- Common communication cassettes



Software support

- PLCopen libraries
- Integration files for electrical and mechanical CAD systems (ePLAN and 2D/3D CAD)



Common accessories

- Communication modules (cassettes)
- EMC filters
- Braking resistor
- Line chokes



Schneider Electric Industries SAS

Head office:
35 rue Joseph Monier
CS 3032392506
Rueil-Malmaison Cedex
France

www.schneider-electric.com

ART : 837696

Due to possible changes in standards and equipment, the features described in this document in the form of text and images are subject to confirmation by Schneider Electric.
Designed and created by: Gavrinis
Photos: Schneider Electric - Shutterstock

Date : 11.2009